

7800 Series Deadlatches



LATCH BOLT HELD RETRACTED BY STOP IN FRONT

- 7802** By Key outside, handle inside
- 7802 1/4** By Key either side



CASE:
Heavy Gauge Steel

ARMOR FRONT:
Brass, bronze or stainless steel. Adjustable bevel.

LATCH BOLT:
Bronze-5/8" x 1" x 1/2" throw

When ordering, please specify:

- HANDING
- FINISH (Standard and custom finishes available)

CYLINDER HOLD BACK OF LATCH BOLT AVAILABLE

- 7804** By Key outside, handle inside
-No hold back feature
- 7804 1/4** By Key either side
-No hold back feature
- H7804** By key outside, handle inside
Latch bolt held retracted by depressing, then turning outside key
- H7804 1/4** By key either side
Latch bolt held retracted by depressing, then turning inside key
- H7805 1/4** By key either side, handle inside
Latch bolt held retracted by depressing, then turning inside key



**FOR MARINE USE:
FOR LOCKS COMPLETELY MADE OF STAINLESS STEEL AND OTHER NON-FERROUS MATERIALS PREFIX PART NUMBER WITH SS (e.g. SS H7804)**

7800 HANDLE AVAILABLE AND FURNISHED AT EXTRA COST— Please specify

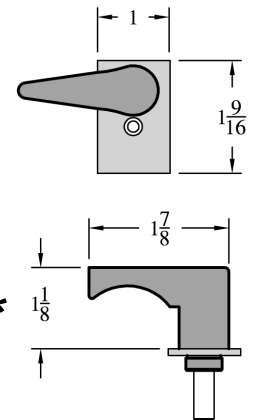
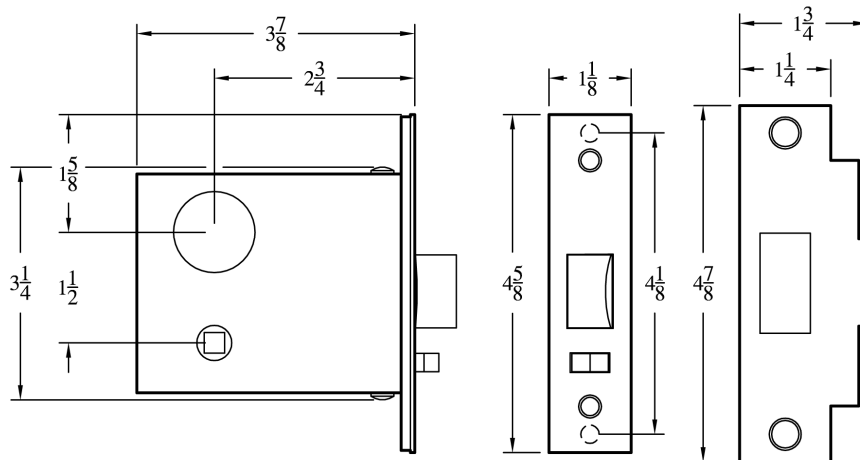

* A modified version of the 7800 handle is offered to meet California code (p/n 7800CA)